

## Geset 114 TE (Mat.-No.: 40012475)

### Characteristics:

- Two-side seal labeling of square products at side and top-/bottom side
- System on rubber feet
- Robust steel base frame
- Simple unmistakable operation by buttons
- Proven and reliable applicator technique provided by Alpha Compact, 120mm label width
- Performances of up to 100 products per minute are possible

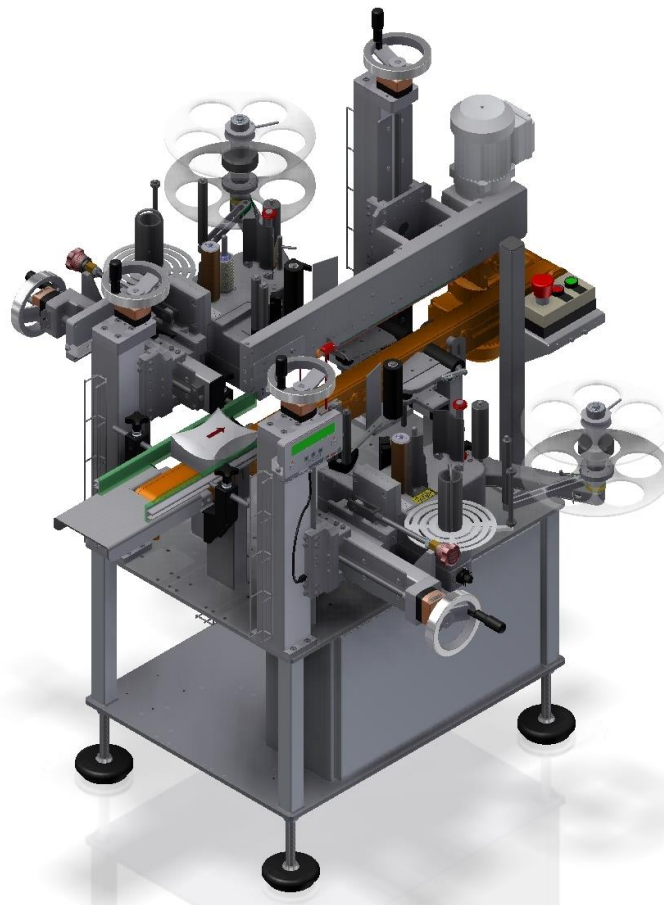

## Depiction of labeling procedure

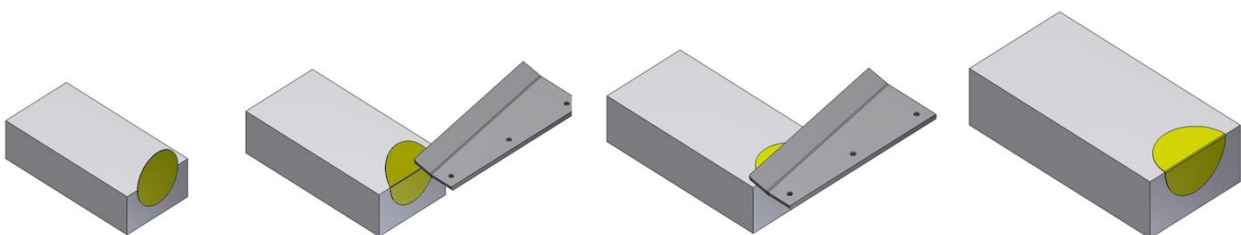

## Description of application

Square products are placed onto the conveyor belt either manually or automatically. The product is then forwarded to the applicator. It is essential that the products are forwarded separately . with a gap to each other . to the applicator. When the light barrier is reached, an application trigger is tripped. Both label applicators apply then in Wipe On procedure a label onto the product. The labels are applied on the side and they overlap a certain part for selection to topside or bottomside of the product. The overlapping part is then turned over after labeling by crank sheets.

After labeling the products move on and can be removed from conveyor by the customer.

## System configuration

The system consists in detail of:

- 1 pc. Machine frame steel varnished RAL 7035
  - Open construction, on rubber feet
  - Working height 850mm +/-50mm
- 1 pc. Switch cabinet RAL 7035
  - Connection 230V/50Hz
  - Incl. two frequency converter
  - Button box: EMERGENCY OFF, Conveyor ON/OFF
- 1 pc. Small belt conveyor
  - Width 50mm (Belt width 40mm); center distance 1140mm
  - Speed 20 m/min, adjustable
- 1 pc. Top conveyor, Speed 20 m/min, adjustable
- 2 pcs. Alpha Compact Working width 120mm
  - Righthand and lefthand version
  - Max. label roll diameter 300mm
  - Incl. HMI Display
  - Incl. label detection ultra sonic light barrier
  - Incl. pusher roller
- 2 pcs. Mounting label applicator
  - Consisting of aluminium profile
  - Incl. horizontal- and vertical adjustment
  - Repeatable setting by digital display
  - Incl. Gimbal
- 2 pcs. Starting pulse emission
- 4 pcs. Crank sheets
  - For corner-wrap deflection of the labels
- 1 pc. Side guidance
- 1 pc. Infeed sheet

## Machine characteristics

Geset 114 TE:	
Electrical connection:	230V / 50Hz
Power consumption:	1,5 kW
Weight:	appr. 200kg
Varnish:	RAL 7035
Conveying speed:	20 m/min (frequency-controlled +/-20%)
Application rate:	Up to 100 pcs/min, depending on product- and label size
Running direction:	From lefthand to righthand (R)
Operator side:	In running direction lefthand (A) and righthand (B)
System connection:	In running direction lefthand (A) and righthand (B)
Reference edge:	Centered
Width of conveyor:	40mm (Total width of conveyor belt 50mm)
Working height:	850mm +/- 50mm
Protection class:	IP 40
Label rolls, outside diameter:	Ø =300 mm (corresponds to 450 mm) core = 76 mm (3 %)
Label size:	Min. 20 x 20 mm (W x H) Max. 120 x 300 mm (W x H) Minimum label gap 3mm
Application accuracy:	+/- 1 mm

## Product characteristics

Geset 114 TE:	
Product distance to each other [M29]:	<b>Min:</b> 100mm
Application rate:	$(\text{Speed of base conveyor [m/min]} * 1000 / (\text{Product distance [mm] [M29]} + \text{Product length [mm] [M8]})) * 0,95$
Width [M7]:	<b>Min:</b> 70mm (depends on label size that is turned over) <b>Max:</b> 180mm
Length [M8]:	<b>Min:</b> 30mm <b>Max:</b> 250mm
Total height [M9]:	<b>Min:</b> 10mm <b>Max:</b> 150mm
Weight	<b>Min:</b> 30g <b>Max:</b> 500g

